

SIDE A

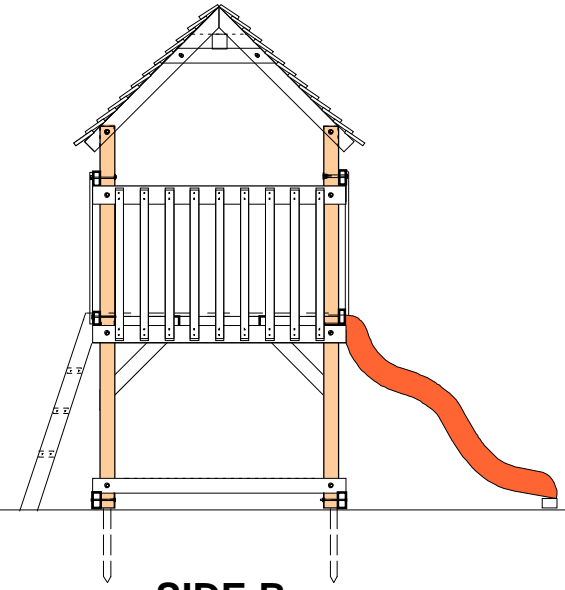

SIDE B

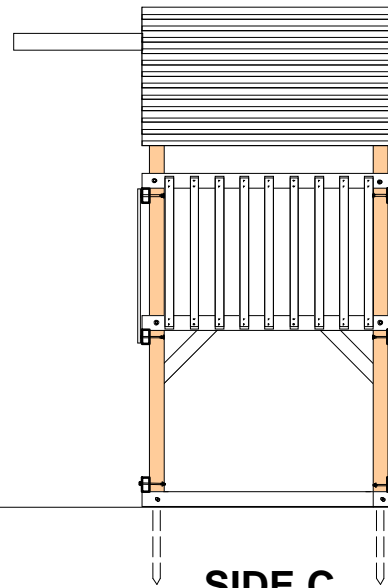
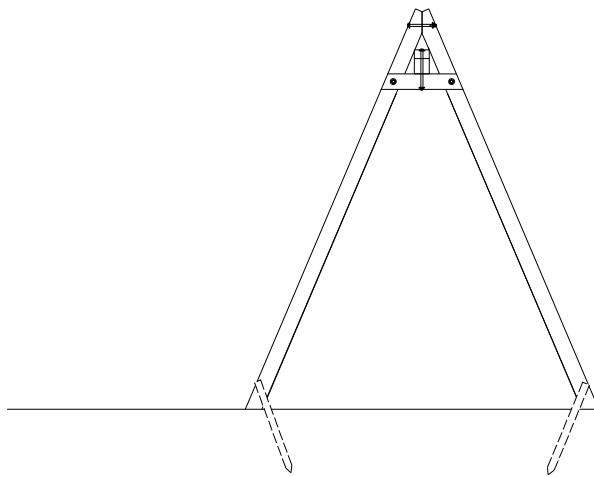

SIDE C

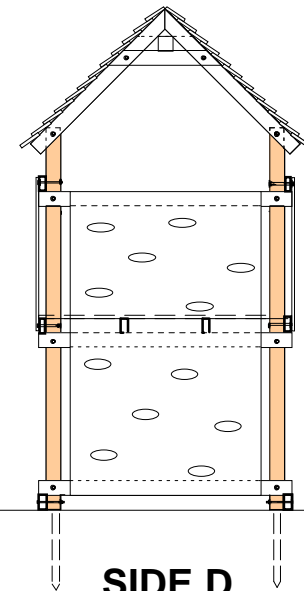

SIDE D

(Can be substituted with side B if climbing wall is not required)

Quantities and Cutting List

NOTE :

TIMBER USED SHOULD BE MINIMUM H3.2 TREATED NO1 DRESSED AND GAUGED. Timber sizes referred to on this plan are the size of the timber once it has been dressed and gauged, eg. 100x50 rough sawn timber is approximately 90x45 after it has been dressed and gauged.

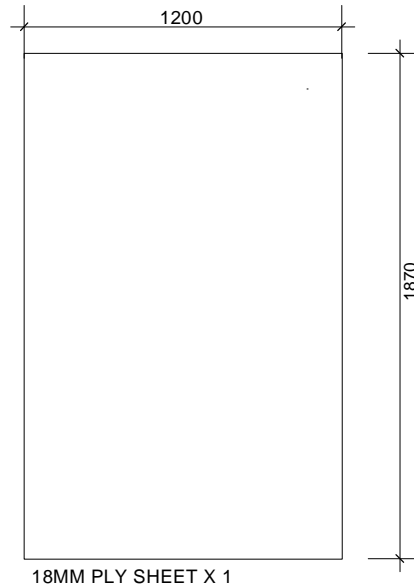
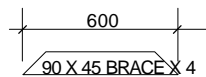
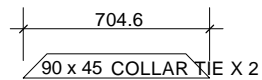
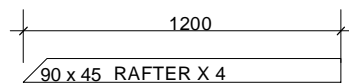
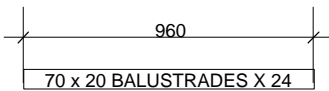
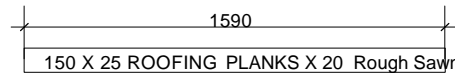
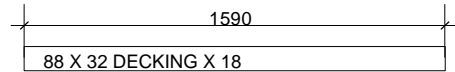
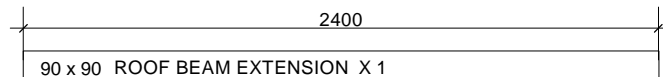
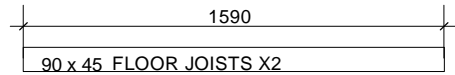
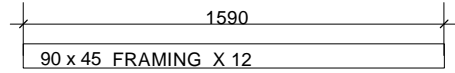
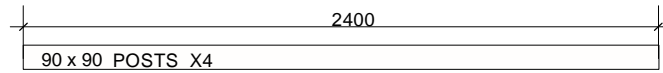

SWING EXTENSION

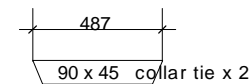
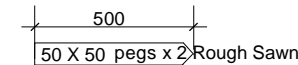
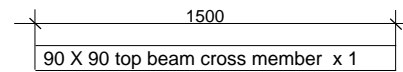
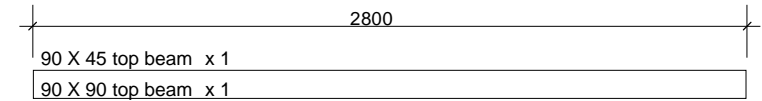
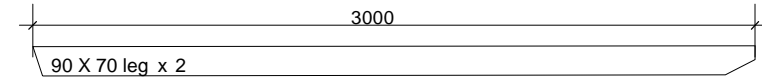

- GALVANISED CUP HEAD COACH BOLTS**
- 10mm X 220 mm x 2
 - 10mm X 150 mm x 1
 - 10mm X 160 mm x 2
 - 10mm X 180 mm x 2
 - PLUS WASHERS x 7

LADDER

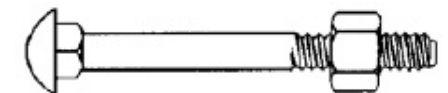
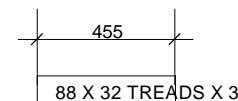
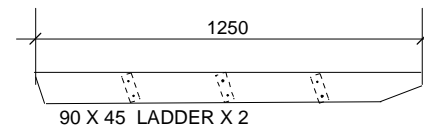

- GALVANISED CUP HEAD COACH BOLTS**
- 10MM X 130MM X 28
 - 10MM X 100MM X 4
 - 10MM X 120MM X 2
 - WASHERS X 34
 - NAIL PLATE X 2

Familiarise yourself with the Fort Plans.

Plan your playground area! Swing and climb components and accessories can be added to the play fort as part of the initial construction or at any time in the future.

If you have your play fort configuration and playground area well planned, the play fort structure can grow with your children.

Choose your build options.

You can order timber pre cut to size from your local timber merchants. Or cut wood to size yourself.

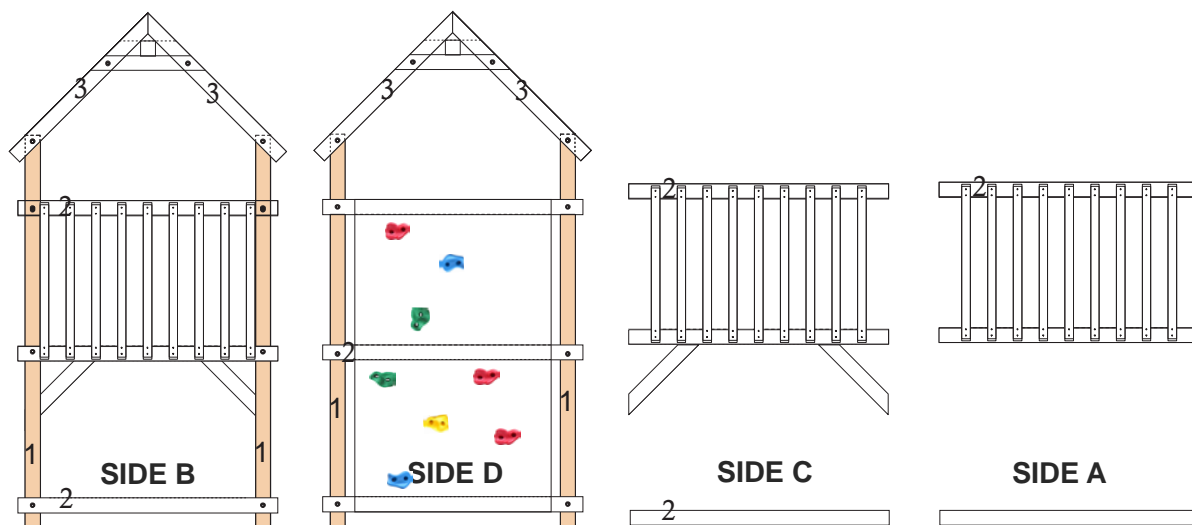

Assemble sides A,B,C and D.

It is a good idea to build the frames B and D up on blocks so your hand can reach underneath to place nuts and washers.

Place all the posts (1) together and measure and mark sides B and D,

Measure and mark rafters (3) to suit roof planks,

Measure and mark framing (2) to suit balustrades and posts.

Drill all the bolt holes to 11mm. Counter Sink bolt holes to 15mm deep, 25mm wide.

Make sure nuts or bolt threads or nuts do not protrude more than 8mm (collar tie bolts, threads and nuts are out of harms way and do not need to be counter sunk.)

Fix the plywood sheet to the posts using 50mm screws at 150mm spacing.

Once your four sides are prepared as shown, stand sides B and D up and join together with sides A and C.

Complete your play fort by adding floor, roof planks, ladder and beams.

Peg into ground and make sure all bolts are tight.

Note: The deck height on these plans will suit the most commonly available playground slides. ie.1200mm.

(We have playground slides available to suit deck heights from 900mm to 1500mm)

Before you build your fort choose a slide to suit you and your family and adjust the deck height on the plans accordingly.

Build A Safe Play Fort

To avoid fingers getting trapped:

No gaps or holes between 8mm and 25mm.

To avoid head neck, or torso traps: No gaps or holes between 90mm and 230mm.

Check all openings on the play set such as between ladder rungs, posts and railings. Check for any sharp points or edges on the play set that may cause injuries.

To maintain the safety of your play set regular inspections must be undertaken. Inspect for any damage and splinters. Loose connections, fasteners and shackles: tighten or replace if necessary.

The play set must be securely anchored to prevent it from turning over. If soil conditions allow stakes to be pulled out, cementing will be required.

Swing Seats should have a ground clearance of not less than 350mm when laden.

Consider shock-absorbing protective surfacing Under and around your play equipment.



Play Safe

Do not allow children to wear bike helmets or clothes like hoodies with long neck drawstrings or straps on play sets.

Attaching cords or ropes of any kind on play sets may be a strangulation hazard.

Anchor climbing ropes at both ends.

Smaller children may need to be supervised around climbers and swings and made aware of swing clearances. Ensure your children and their friends know how to play appropriately on and around play sets.

Copyright 2 much fun Ltd 2010

Only your personal use of this plan is permitted, which means that you may access, download, or print for your personal use only.

Commercial use of any sort is expressly prohibited.

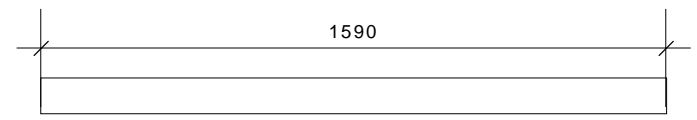
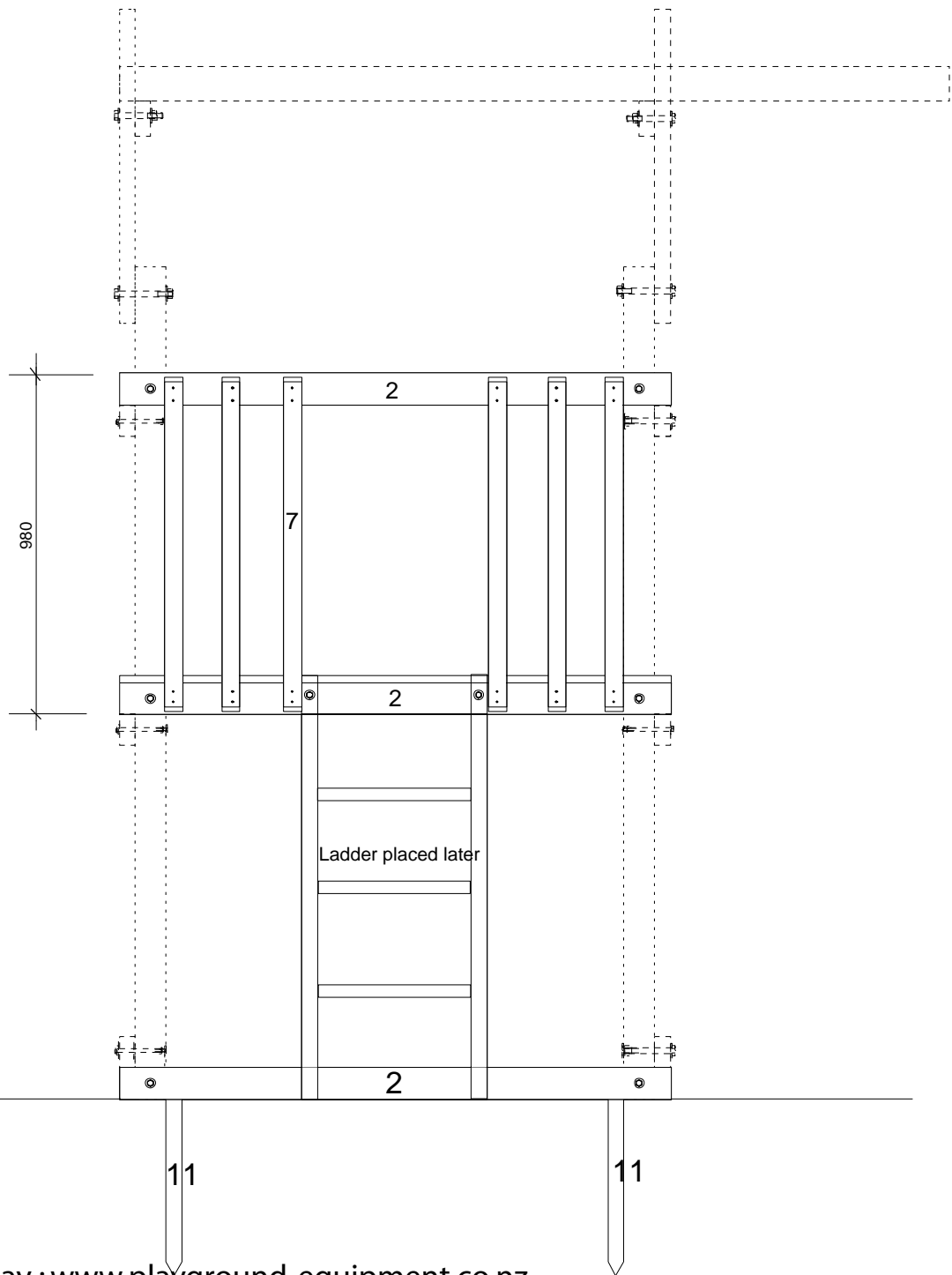

2 90 X 45 FRAMING X 3

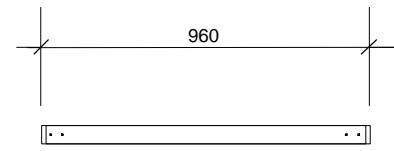

7 70 x 20 BALUSTRADES X 6 cut at 45°

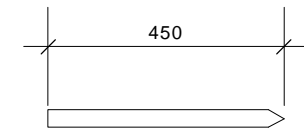

11 50 x 50 PEGS X 2 Rough Sawn



10MM X 130MM CUP HEAD COACH BOLTS X 6
WASHERS X 6

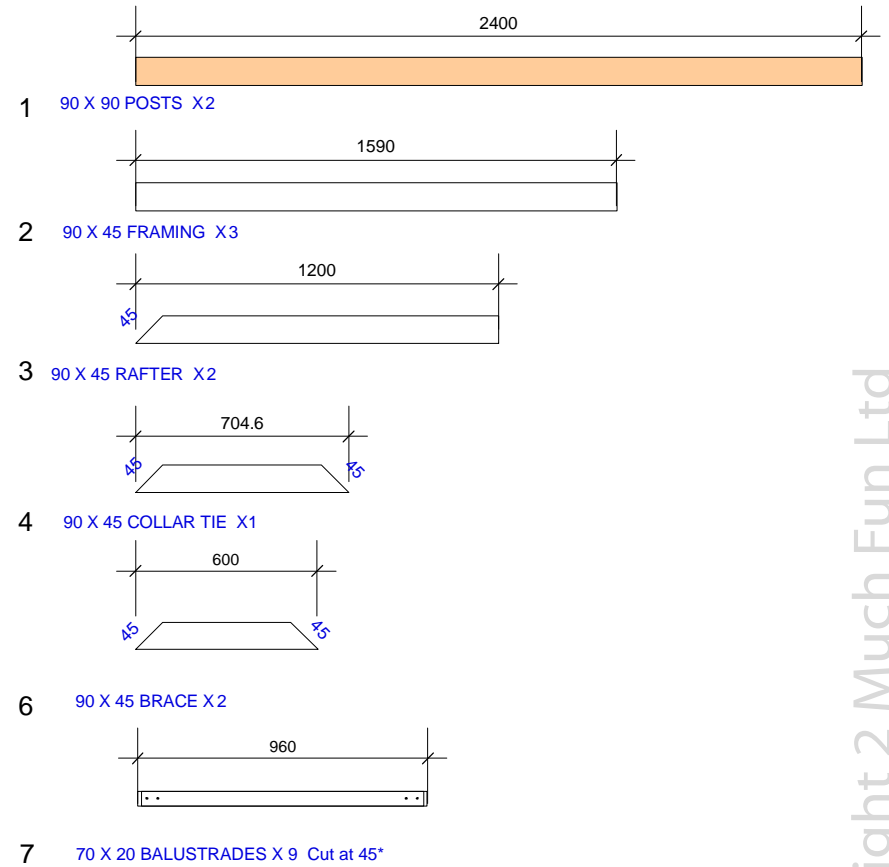
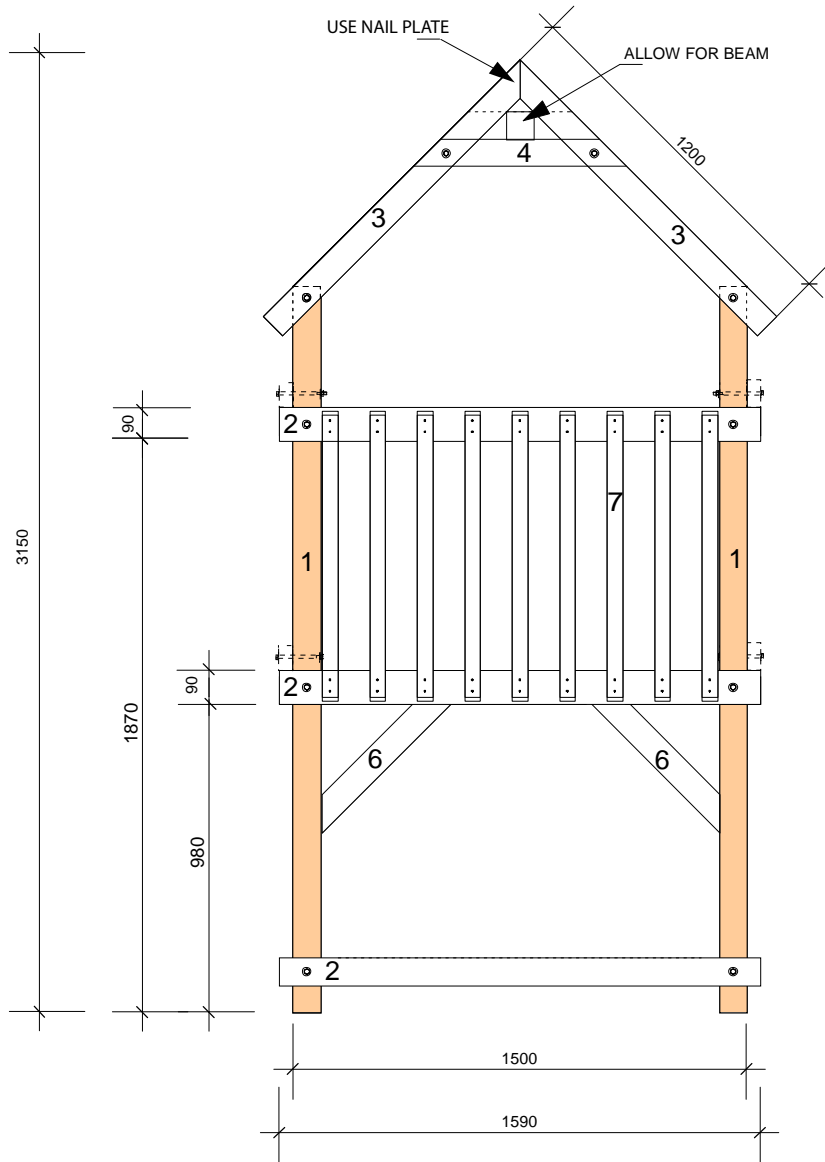

- 10MM X 130MM CUP HEAD COACH BOLTS X 8
- 10MM X 100MM CUP HEAD COACH BOLTS X 2
- WASHERS X 10
- NAIL PLATE X 1

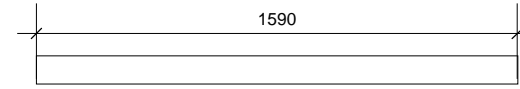
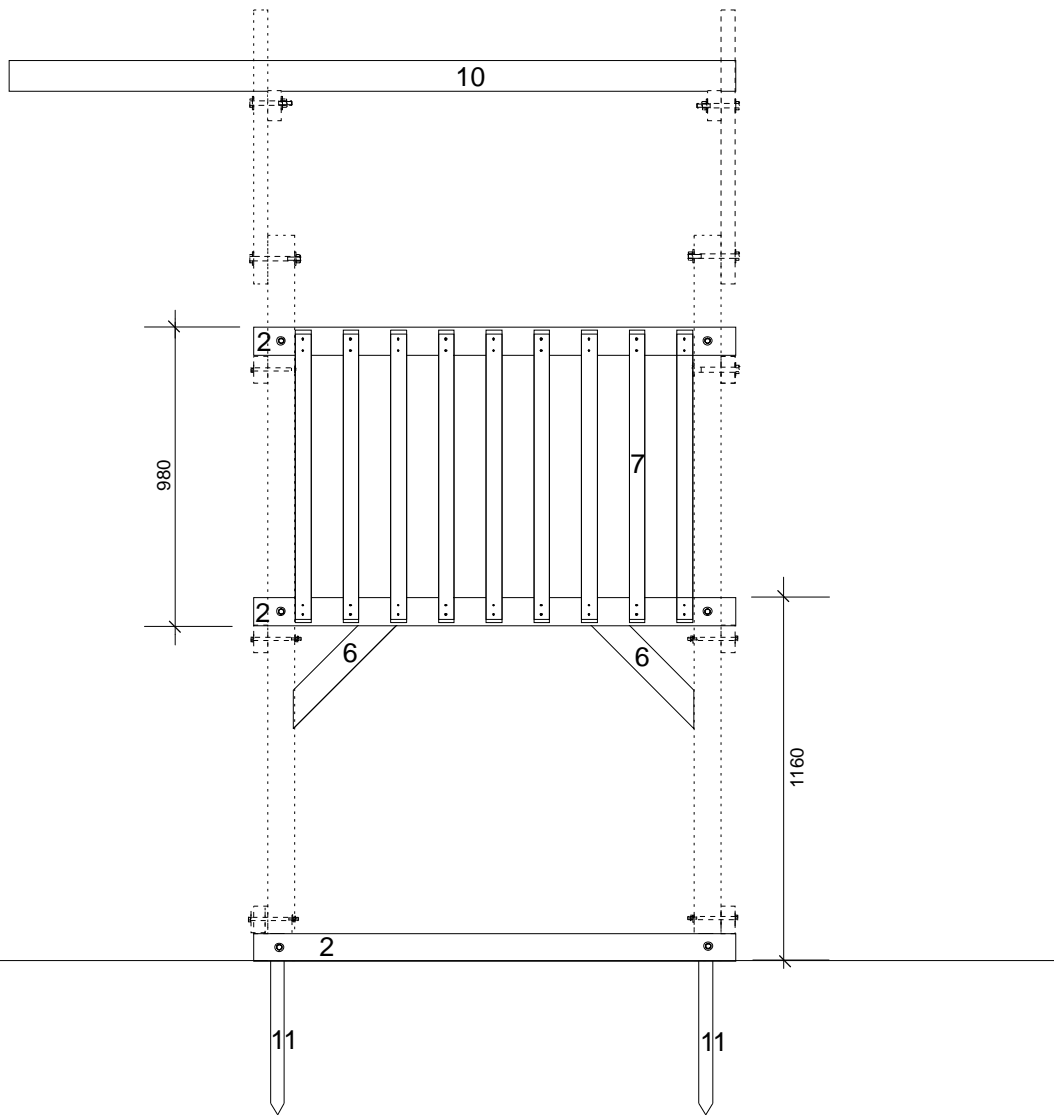

2 90 X 45 FRAMING X 3

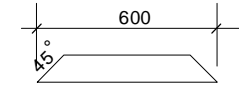

6 90 X 45 BRACE X 2

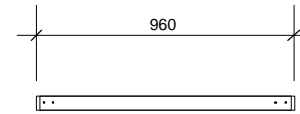

7 70 X 20 BALUSTRADES X 9 Cut at 45* Remove 4 or 5 Balustrades from cutting list if adding a slide.

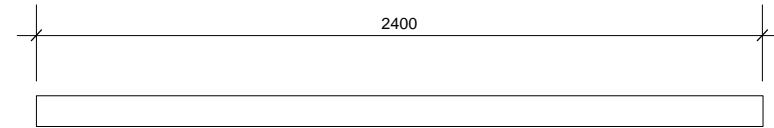

10 90 X 90 ROOF BEAM EXTENSION X 1 Optional Beam. Not suitable for hanging swings on. Suitable for hanging: Delta Trapeze, Delta Rings, Rope Ladder or Fireman Pole. Remove from cutting list if not required.

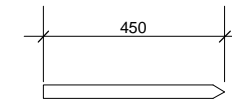

11 50 X 50 PEGS X 4 ROUGH SAWN



10MM X 130MM CUP HEAD COACH BOLTS X 6
WASHERS X 6

Note: If you do not want a climbing wall on your play fort substitute side D with side B (sheet 5) and adjust cutting list to suit.

SIDE D

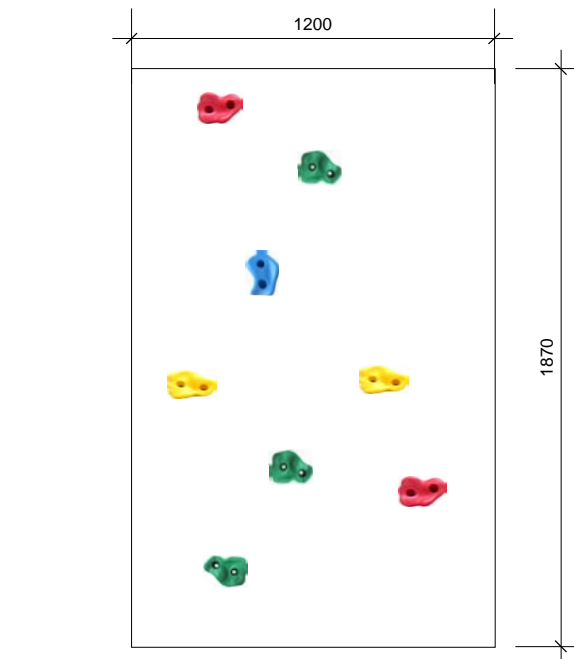
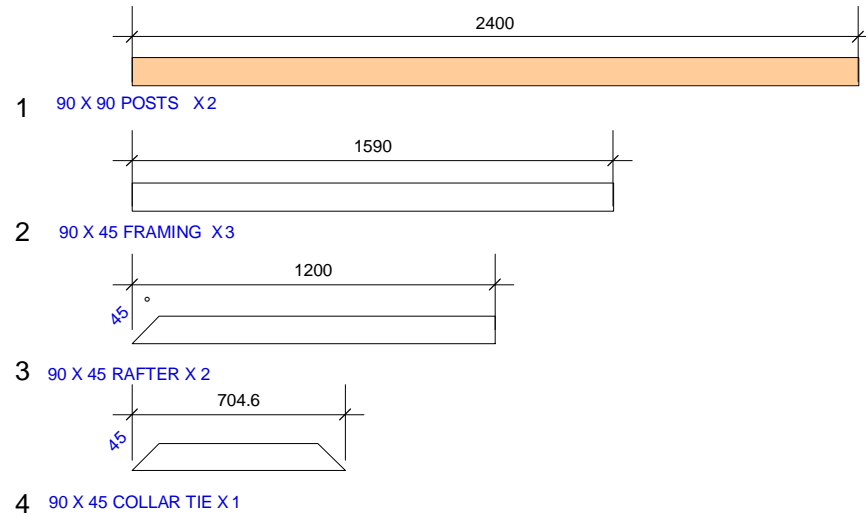
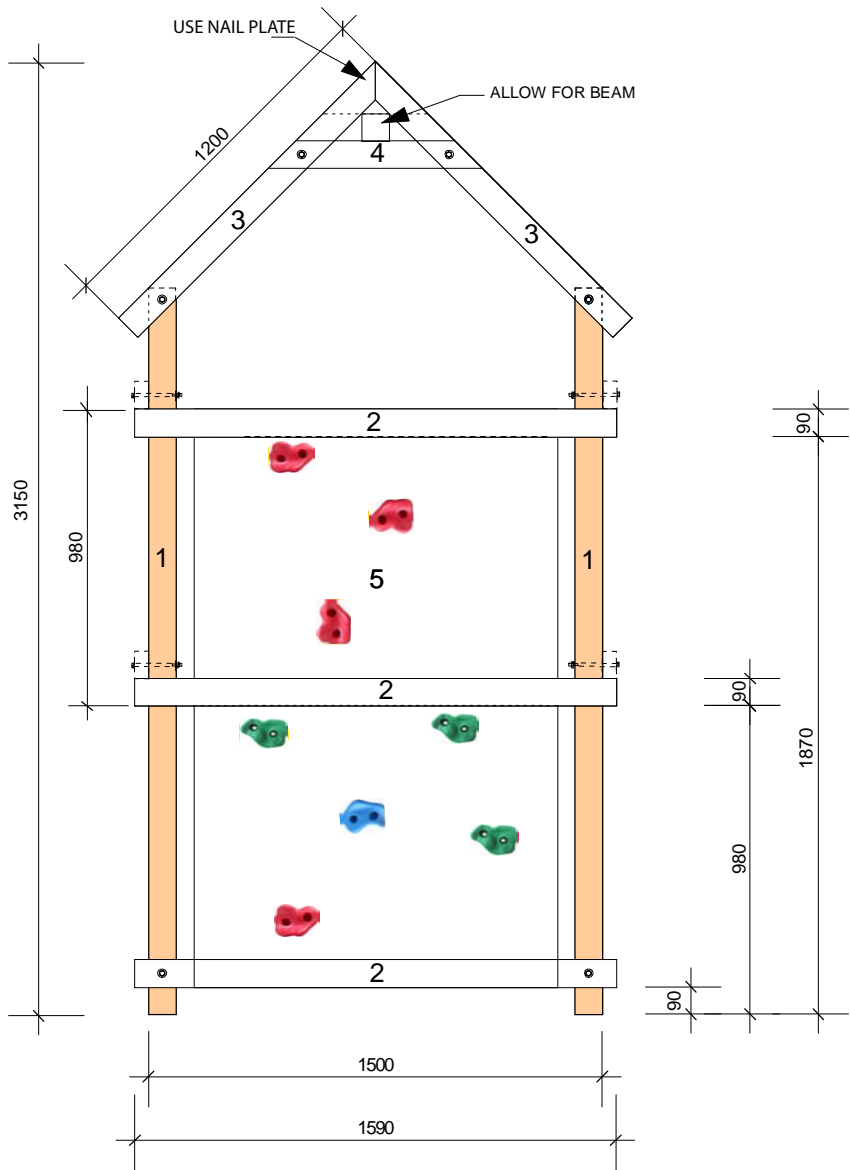

- 10MM X 130MM CUP HEAD COACH BOLTS X 8
- 10MM X 100MM CUP HEAD COACH BOLTS X 2
- WASHERS X 10
- NAIL PLATE X 1

Copyright 2 MuchFun Ltd

ROOF

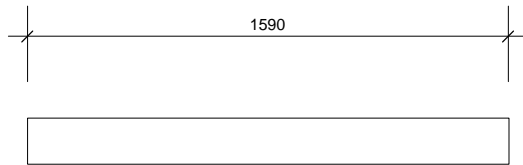
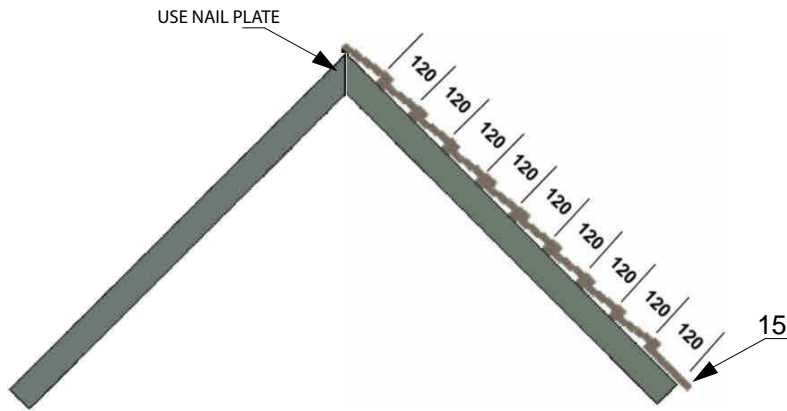

15 ROOFING PLANKS 150 X 25 X 20 Rough Sawn

MID FLOOR

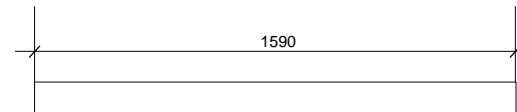
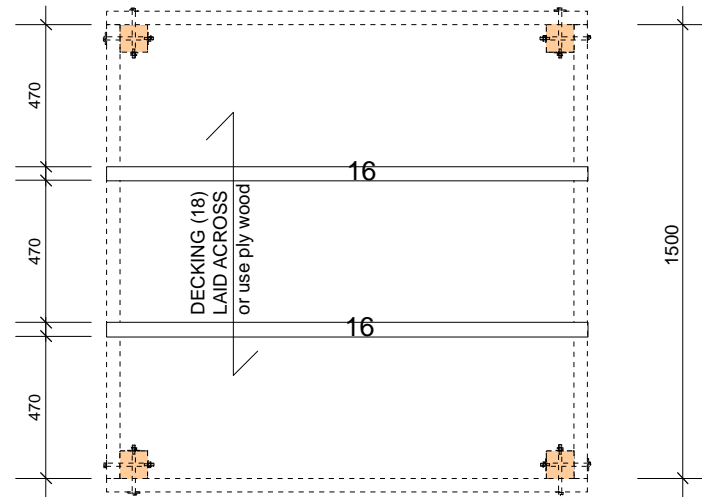

16 FLOOR JOISTS 90 X 45 X 2

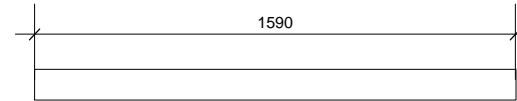

17 DECKING 88 X 32 X 18 (or use ply wood)

SWING OPTION

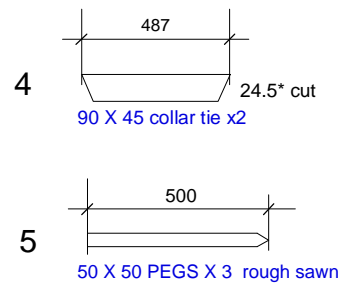
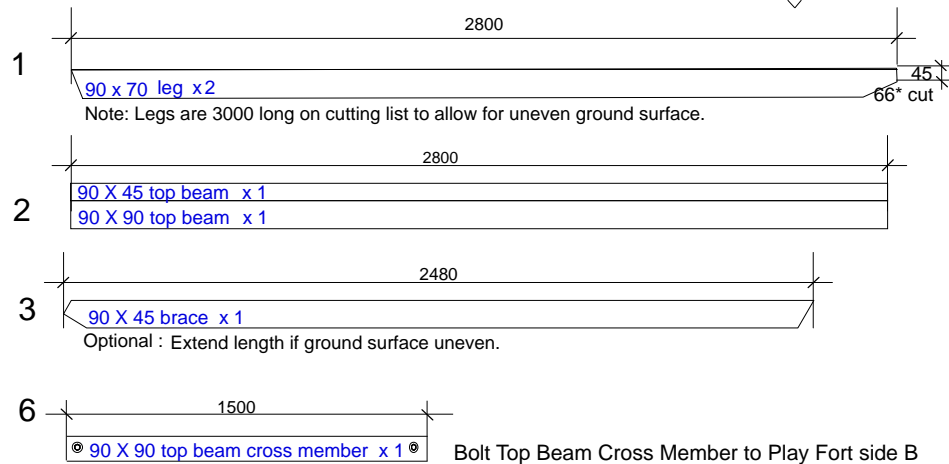
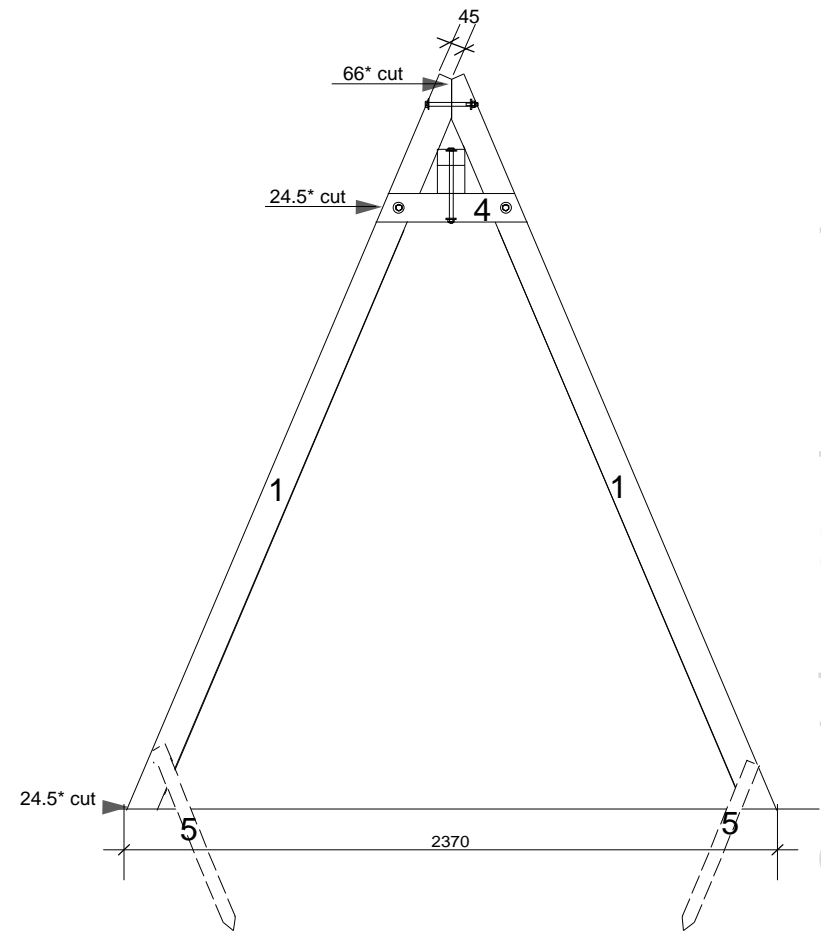
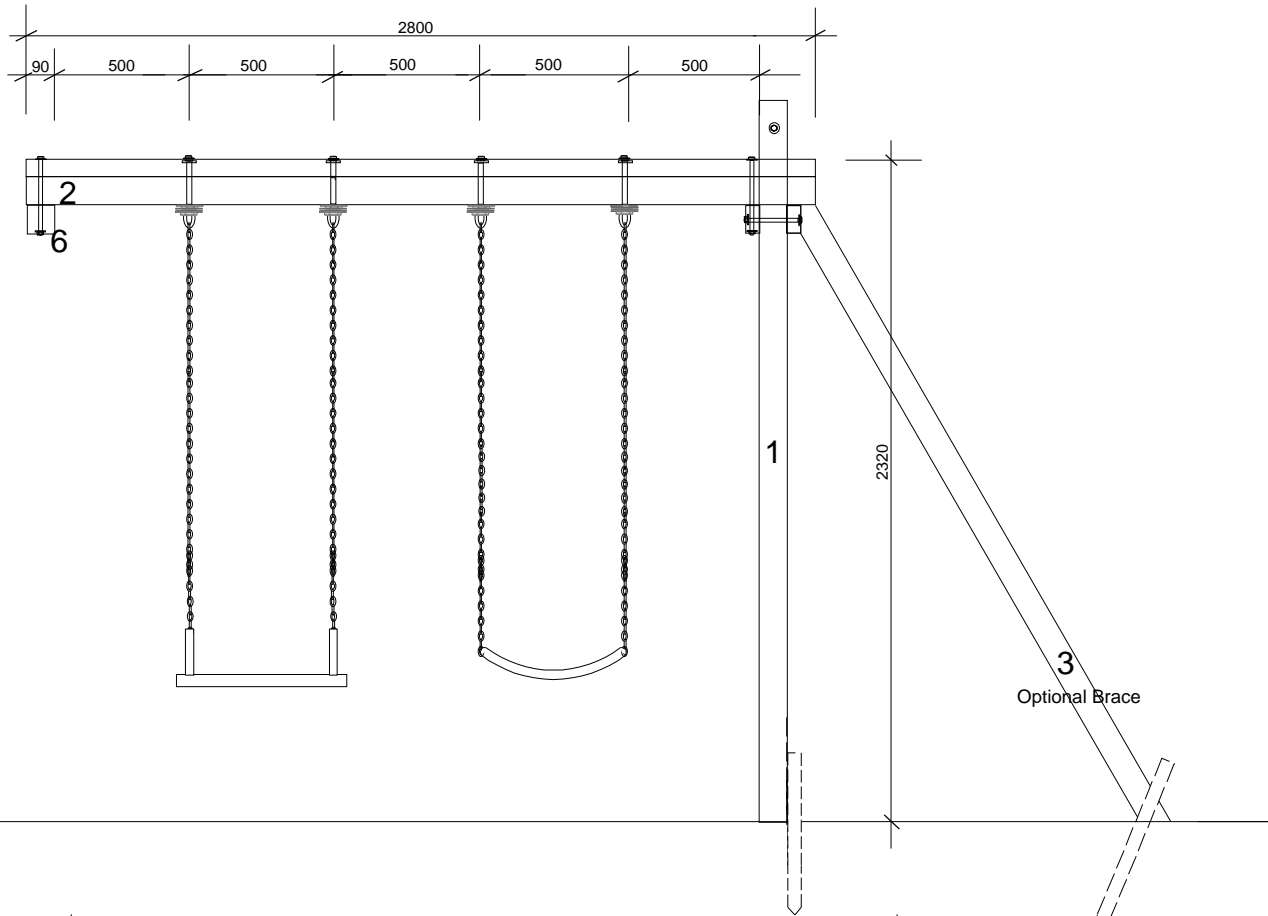

- 10mm X 220 mm CUP HEAD COACH BOLTS x 2
- 10mm X 150 mm CUP HEAD COACH BOLTS x 1
- 10mm X 160 mm CUP HEAD COACH BOLTS x 2
- 10mm X 180 mm CUP HEAD COACH BOLTS x 2
- PLUS WASHERS

Copyright 2 Much Fun Ltd

Ladder

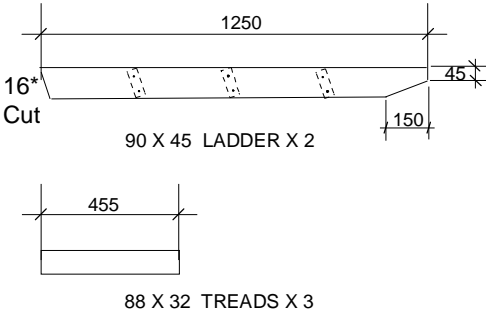
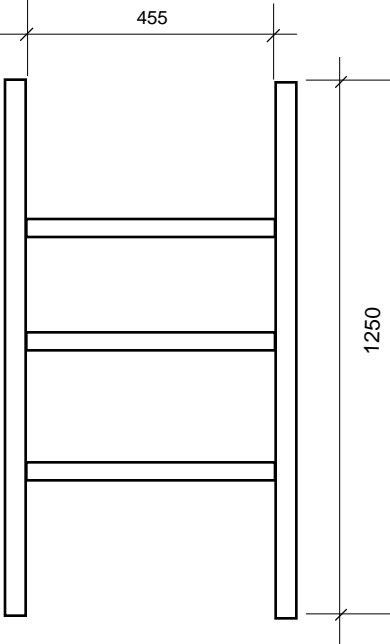
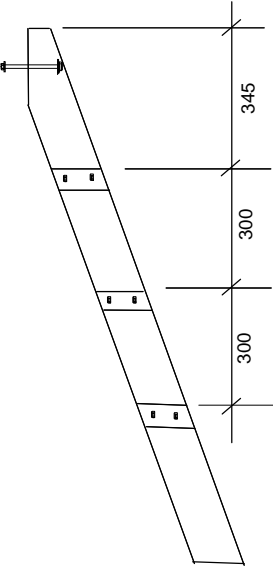

10MM X 120MM CUP HEAD COACH BOLTS X 2